

GROUND FLOOR
644 sq.ft. (59.8 sq.m.) approx.

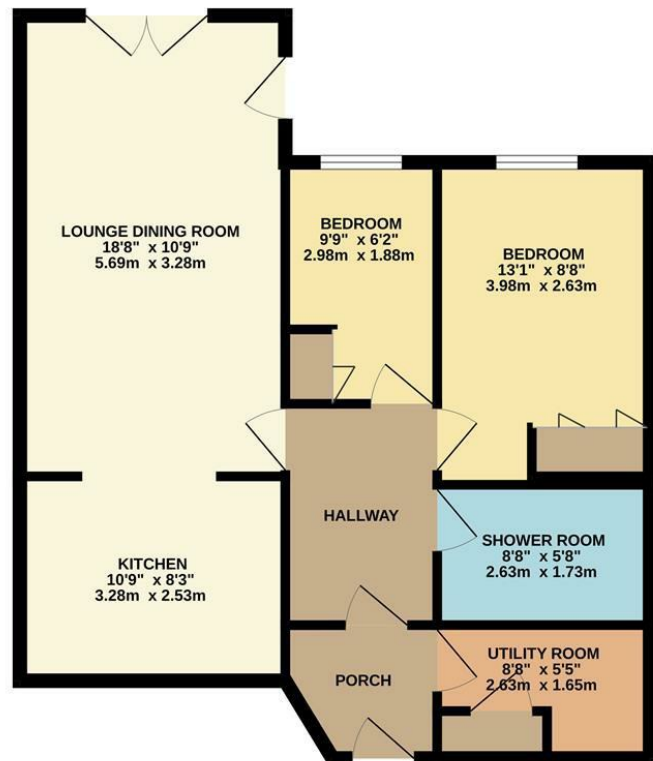

TOTAL FLOOR AREA: 644 sq.ft. (59.8 sq.m.) approx.
Whilst every attempt has been made to ensure the accuracy of the floorplan contained here, measurements of doors, windows, rooms and any other items are approximate and no responsibility is taken for any error, omission or mis-statement. This plan is for illustrative purposes only and should be used as such by any prospective purchaser. The services, systems and appliances shown have not been tested and no guarantee as to their operability or efficiency can be given.
Made with Metropix ©2024

Flat 3, 16, Carlton House Regent
£175,000

charlesrose.



This ground floor, two bedroom over 55's retirement apartment is located in the heart of Leamington town centre. The property is well-presented throughout, featuring: entrance hall, lounge dining room, fitted kitchen, two bedrooms, bathroom and utility room.

As you enter the building you reach the communal entrance, where there is a pleasant communal living area and on-site support as well as access to the under ground secure parking and elevators. Within the development there is also a communal roof terrace garden available for the residents as well as three reception rooms, wash facilities and a guest suite for visiting friends or relatives.

charlesrose.

- 01926 832411
- hello@charlesrose.co.uk
- charlesrose.co.uk

