

10 Newbold Place, Leamington Spa
Guide Price £315,000

charlesrose.

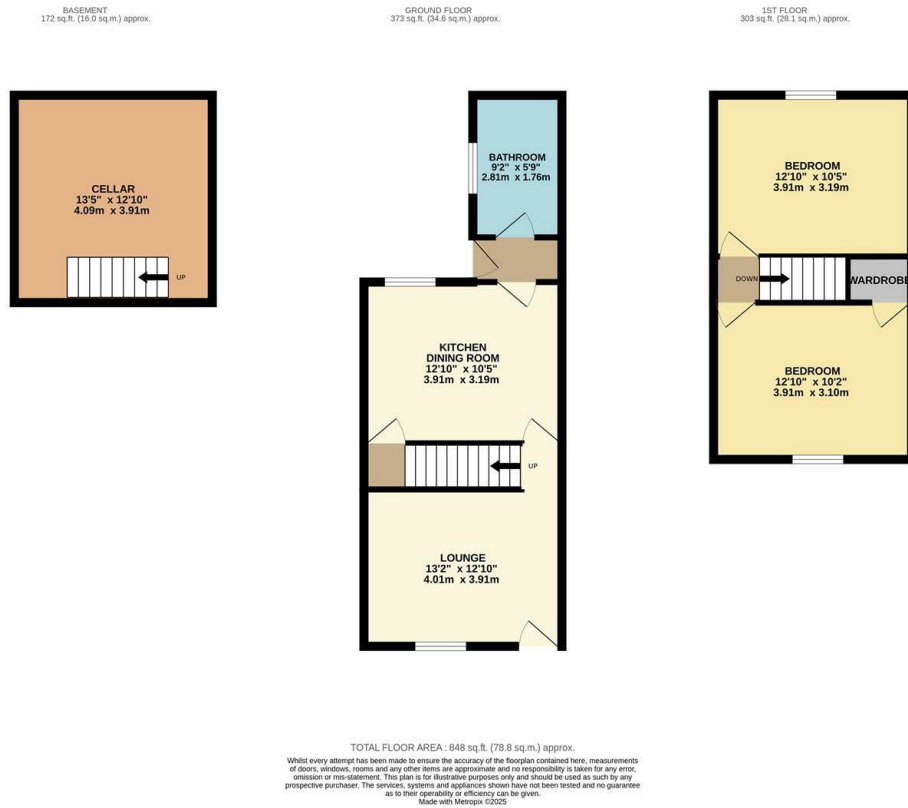

This charming Victorian terrace has been stylishly updated by the present owner. The accommodation offers two double bedrooms, lounge, kitchen dining room and a bathroom. The property also features a cellar and a courtyard garden. Benefitting from being situated in the heart of the town centre, Jephson Gardens is a stones through away. The Parade is a short stroll, whilst the train station is only a 0.6 mile walk too. This property really would make a superb first time buy.

charlesrose.

- 01926 832411
- info@charlesroseproperties.co.uk
- www.charlesroseproperties.co.uk

