

10 Alder Meadow, Warwick
£1,050 Per Month

charlesrose.

FIRST FLOOR
610 sq.ft. (56.6 sq.m.) approx.

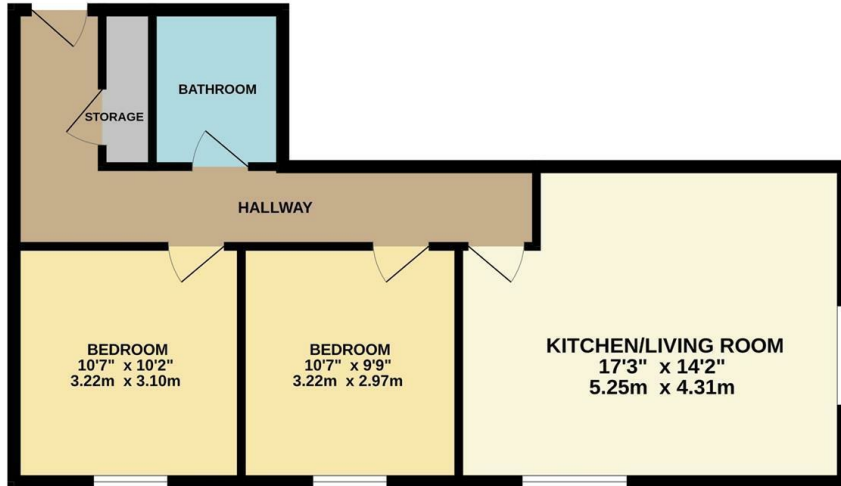

TOTAL FLOOR AREA: 610 sq.ft. (56.6 sq.m.) approx.
Whilst every attempt has been made to ensure the accuracy of the floorplan contained here, measurements of doors, windows, rooms and any other items are approximate and no responsibility is taken for any error, omission or mis-statement. This plan is for illustrative purposes only and should be used as such by any prospective purchaser. The services, systems and appliances shown have not been tested and no guarantee as to their operability or efficiency can be given.
Made with Metropix ©2023



The accommodation comprises entrance hall, open plan lounge/kitchen/dining room with white goods, master bedroom, second bedroom and bathroom. It has recently been decorated, new electric heater installed and carpets laid.

The apartment benefits from its proximity to the local amenities such as convenience store and doctors surgery and also the A46, M40 and the local railway network. Outside the apartment, there is an allocated parking space, as well as plenty of green space to enjoy.

Available from 12/05/2025

EPC - C
Council Tax - Band C
No Students
No Sharers

charlesrose.

- 01926 832411
- info@charlesroseproperties.co.uk
- www.charlesroseproperties.co.uk

