

GROUND FLOOR
494 sq. ft. (45.9 sq. m.) approx.

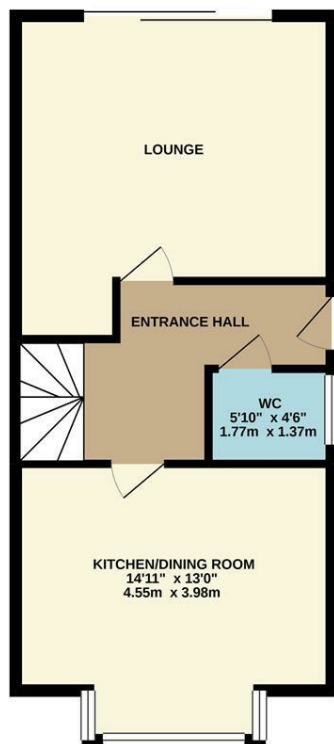

1ST FLOOR
333 sq. ft. (31.0 sq. m.) approx.

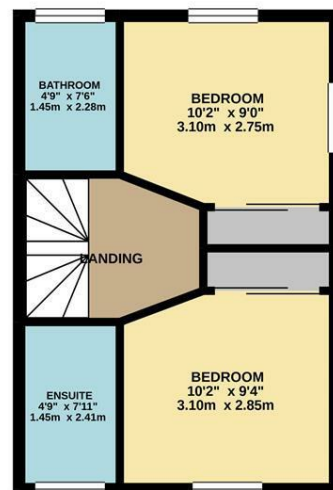

TOTAL FLOOR AREA: 827 sq. ft. (76.9 sq. m.) approx.

Whilst every attempt has been made to ensure the accuracy of the floorplan contained here, measurements of doors, windows, rooms and any other items are approximate and no responsibility is taken for any error, omission or mis-statement. This plan is for illustrative purposes only and should be used as such by any prospective purchaser. The services, systems and appliances shown have not been tested and no guarantee as to their operability or efficiency can be given.
Made with Metreage ©2020

33 Stephenson Close, Leamington
£1,450 Per Month

charlesrose.



A beautiful 2 bedroom property in the sought after location of North Leamington. On the ground floor, the accommodation comprises entrance hall, lounge, W.C. and a large kitchen fitted with integrated appliances. To the first floor, there are two double bedrooms both with ensuite bathrooms.

Outside the property benefits from private parking and a good sized garden to the rear.

Council tax band C

No sharers

No pets

Available now

charlesrose.

- 01926 832411
- hello@charlesrose.co.uk
- charlesrose.co.uk

