

8 Walnut Court 35 Montgomery  
£980 Per Month

charlesrose.

GROUND FLOOR  
506 sq.ft. (47.0 sq.m.) approx.

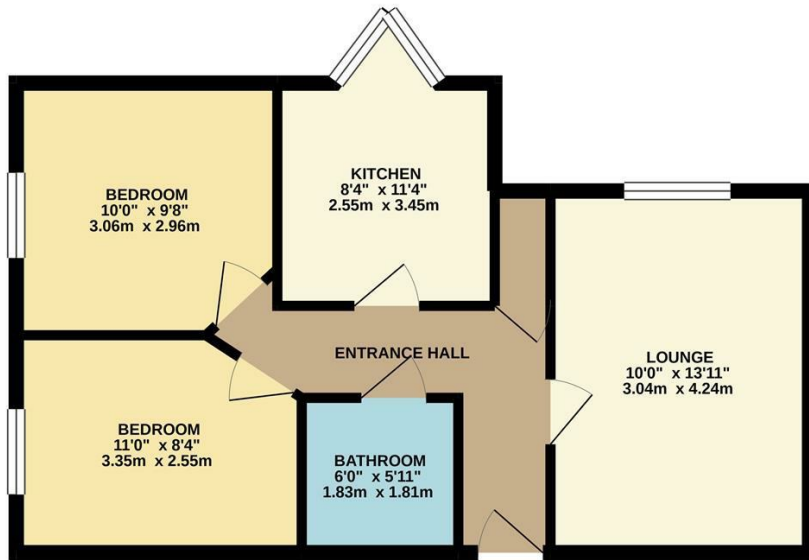

TOTAL FLOOR AREA: 506 sq.ft. (47.0 sq.m.) approx.  
Whilst every attempt has been made to ensure the accuracy of the floorplan contained here, measurements of doors, windows, rooms and any other items are approximate and no responsibility is taken for any error, omission or mis-statement. This plan is for illustrative purposes only and should be used as such by any prospective purchaser. The services, systems and appliances shown have not been tested and no guarantee as to their operability or efficiency can be given.  
Made with Metrepro. ©2021



A very well presented first floor apartment located within easy access onto the M40 or into Leamington Spa Town Centre.

In brief the accommodation comprises; entrance hall, lounge, kitchen, two bedrooms and bathroom. The property is unfurnished and is available from 23/07/2025

This property also benefits from allocated parking.

- Council Tax - band B
- Professional let only
- Single occupant or a couple maximum
- No pets

charlesrose.

- 01926 832411
- hello@charlesrose.co.uk
- charlesrose.co.uk

