

FIRST FLOOR  
809 sq.ft. (75.2 sq.m.) approx.

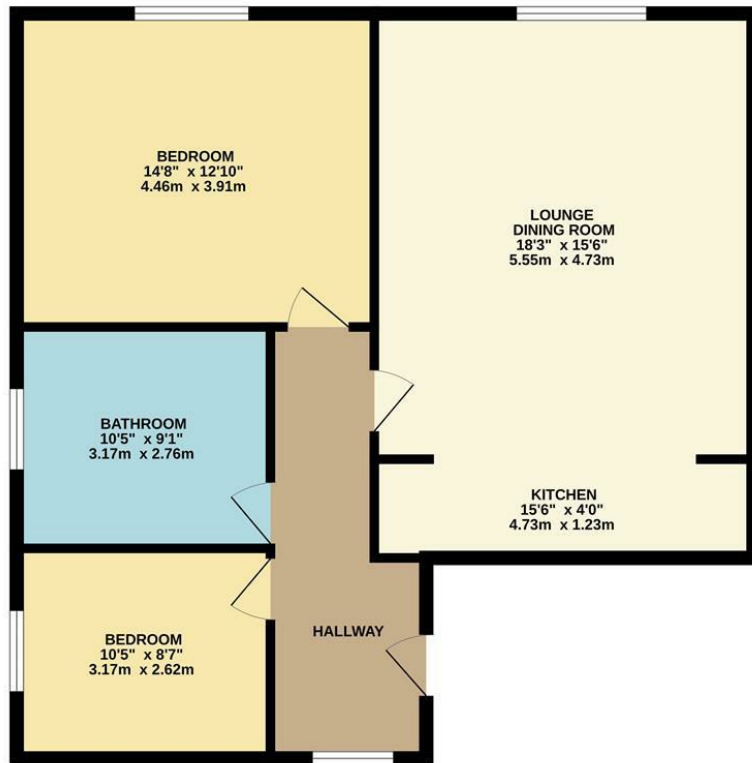

TOTAL FLOOR AREA : 809 sq.ft. (75.2 sq.m.) approx.  
Whilst every attempt has been made to ensure the accuracy of the floorplan contained here, measurements of floors, windows, rooms and any other items are approximate and no responsibility is taken for any error, omission or mis-statement. This plan is for illustrative purposes only and should be used as such by any prospective purchaser. The services, systems and appliances shown have not been tested and no guarantee as to their operability or efficiency can be given.  
Made with Metropix C2025.

32 Portland Place West, Leamington  
£1,495 Per Month

charlesrose.



Situated in the heart of Leamington Spa, this beautifully maintained first-floor apartment forms part of a striking Grade II listed building and offers an abundance of charm and character throughout.

The property features high ceilings and large sash windows, giving a bright and airy feel to the stunning open-plan living, kitchen, and dining area. There are two double bedrooms and a well-sized bathroom featuring a freestanding bath and a separate walk-in shower.

Additional benefits include an allocated parking space at the rear of the property. The apartment is offered on an unfurnished basis.

This is a rare opportunity to rent a spacious, character-filled home in one of Leamington Spa's most desirable central locations.

Sorry no students / no sharers

charlesrose.

- 01926 832411
- hello@charlesrose.co.uk
- charlesrose.co.uk



