

GROUND FLOOR
382 sq.ft. (35.5 sq.m.) approx.

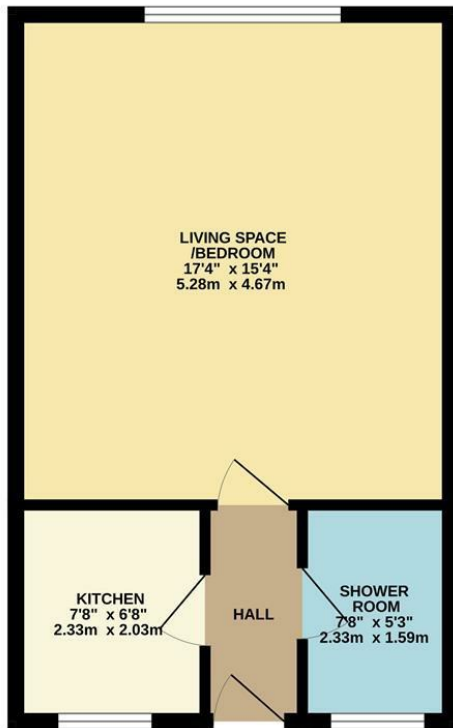

TOTAL FLOOR AREA: 382 sq.ft. (35.5 sq.m.) approx.
Whilst every attempt has been made to ensure the accuracy of the floorplan contained here, measurements of doors, windows, rooms and any other items are approximate and no responsibility is taken for any error, omission or mis-statement. This plan is for illustrative purposes only and should be used as such by any prospective purchaser. The services, systems and appliances shown have not been tested and no guarantee as to their operability or efficiency can be given.
Made with Metropix ©2025

charlesrose.

- 01926 832411
- hello@charlesrose.co.uk
- charlesrose.co.uk

4A Southborough Terrace, Brunswick
£725 Per Month

charlesrose.



A bright and stylish studio apartment ideally located just a short stroll from the town centre, offering both comfort and convenience. The property features beautiful wooden flooring throughout and a modern kitchen complete with white goods.

It is offered unfurnished, giving you the freedom to make it your own space. Due to the size and layout of the studio, the property is considered most suitable for single occupancy. Available now, this apartment is perfect for someone looking for a clean, well-presented home close to local shops, cafés, and transport links.

Holding Deposit £150
Security Deposit: £835

EPC Rating: C
Council Tax Band: A

